

HALF PANEL BLOCK

PANEL BLOCK

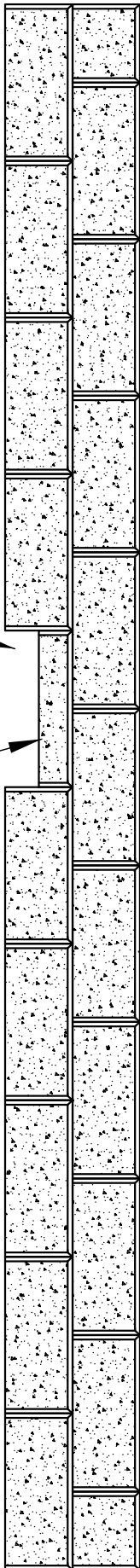

OPENING FOR WATER DRAINAGE (ACTUAL LOCATION IN THE BOND BEAM TO BE DETERMINED BY SITE LAYOUT - ONE PER PANEL MAXIMUM)

ELEVATION VIEW OF BOND BEAM

LITE PANEL BLOCK

9 ga WIRE STIRRUPS PLACED IN BOTH CORES OF THE LITE PANEL BLOCK

OPTIONAL SUBSTITUTION FOR STIRRUPS - 9 ga WIRE LIFTING HOOKS FOR PRECASTED BOND BEAMS ONLY

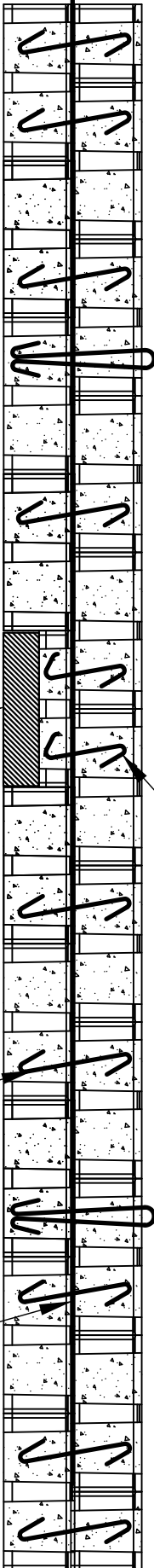

WOOD SPACER (4x4 cut to fit) OR RIGID FOAM TO BE REMOVED AFTER BOND BEAM HAS CURED

9 ga WIRE STIRRUPS IN FIRST TWO CORES FROM EACH END AND EVERY OTHER CORE THEREAFTER (WITH ONE PER BLOCK MINIMUM)
#4 (10M) HORIZONTAL STEEL

LONGITUDINAL CROSS SECTION

NOTE:
1) WHEN PLACING SAND MIX GROUT, A VIBRATORY STINGER SHOULD BE USED TO AID IN THE PROPER CONSOLIDATION OF GROUT.
2) TEN PANEL BLOCK LONG BOND BEAM SHOWN

DRAINAGE DETAIL

Designed By:

Title:

Checked By:

Scale:
NOT TO SCALE



The purpose of this drawing is for preliminary design only. This drawing should not be used for final design or construction without the certification of a professional engineer registered in the state in which the fence will be built. The accuracy and use of details contained in this document are the sole responsibility of the user. The user must verify each detail for accuracy as they pertain to their particular project.

© 2005 Allan Block

Date:

Project No:

Drawing No: